

| NO | PART#      | REV | NAME   | QTY. | SHIP W/ KIT |
|----|------------|-----|--|------|-------------|
| 1  | 016-008-00 |     | OILITE PLUS BEARING, .875 ID x 1.0 OD x 1.25 | 1    |             |
| 2  | 007-031-00 |     | SET SCREW, 1/4-28 X 3/16, BLACK OXIDE        | 1    |             |

| REVISIONS |   |            |          |
|-----------|---|------------|----------|
| REV.      | DESCRIPTION                                     | DATE       | APPROVED |
| N         | REDRAWN TO STS SPECS                            | 12/30/02   | EGO      |
| O         | ADD WELD NOTES / MOVE 1/4-28 TO FRONT FROM SIDE | 12/8/10    | STRO     |
| 1         | SOLIDWORKS APPROVED                             | 12/15/16   | STRO     |
| AA        | MISys Part# and Revision Change                 | 12/17/2024 | DMS      |

- ASSEMBLY NOTES:
- INSERT SET SCREW (3) BUT DO NOT TIGHTEN AGAINST BEARING

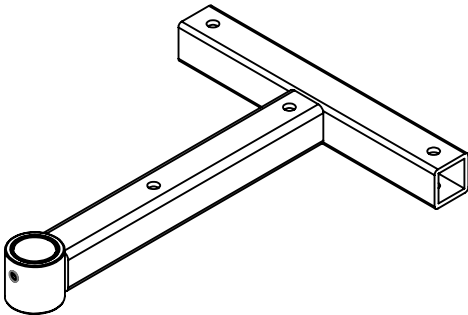
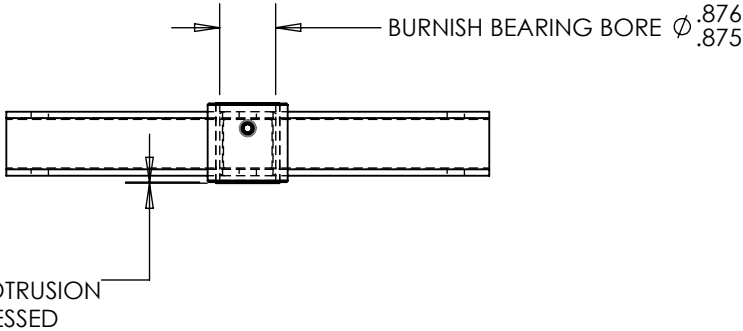
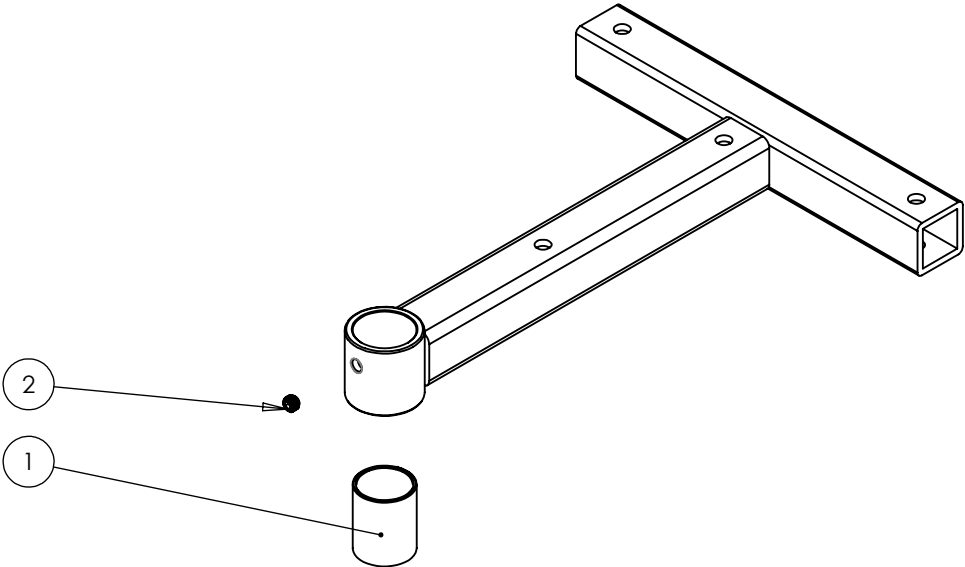

|   |   |  |                           |   |
|---|---|--|---------------------------|---|
| <b>DECTRON LLC</b><br>www.dectronusa.com  |   | TOLERANCE STANDARDS<br>.x   ±.025<br>.xx   ±.010<br>.xxx   ±.005 | PART<br><b>70-0050-00</b> | REV<br><b>AA</b>  |
| <small>PROPRIETARY &amp; CONFIDENTIAL<br/> THE INFORMATION CONTAINED IN THIS DRAWING IS THE SOLE PROPERTY OF DECTRON LLC. ANY REPRODUCTION IN PART OR AS A WHOLE WITHOUT THE WRITTEN PERMISSION OF DECTRON LLC IS PROHIBITED.</small> |   | ANGULAR<br>±2°   | FINISH<br>STEEL           | MATERIAL<br><b>CARDINAL BLACK TEXTURE POWDER COAT T241-BK59</b> |
| SIZE<br><b>A</b>  | DO NOT SCALE DRAWING<br>CHASE<br>05.13.25 |  |                           |   |