

| NO | PART#       | REV | NAME                                | QTY. |
|----|-------------|-----|-------------------------------------|------|
| 1  | 70-0049-PLX | AA  | CONNECTOR PIN, .875OD x 5.0         | 1    |
| 2  | 010-012-00  |     | EXTERNAL RETAINING RING, 7/8" SHAFT | 2    |

APPLY THIS RING BEFORE SHIPPING, ENSURE RING IS FULLY SEATED IN GROOVE

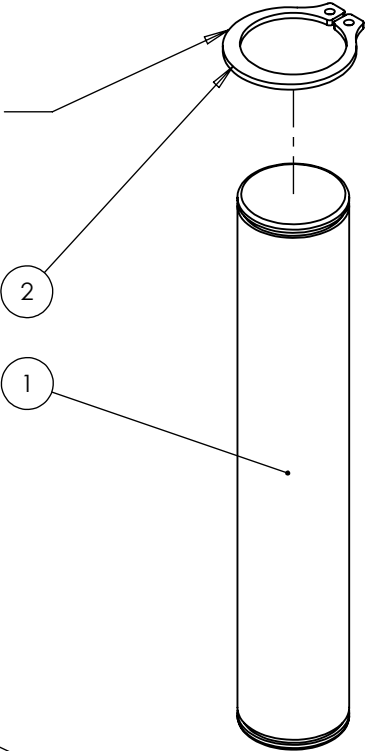

DO NOT APPLY THIS RING, PUT IN SHIP WITH KIT

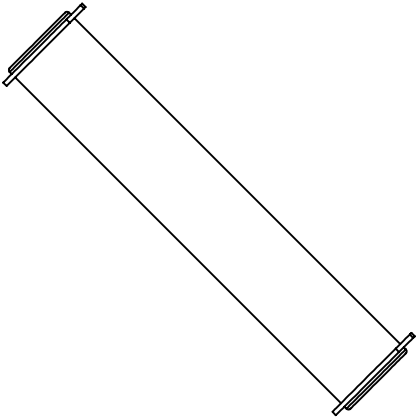

|   |                         |  |  |                  |
|---|-------------------------|--|--|------------------|
| <b>DECTRON LLC</b><br>www.dectronusa.com  |                         | TOLERANCE STANDARDS<br>.x   ±.025<br>.xx   ±.010<br>.xxx   ±.005 | PART<br><b>70-0049-00</b>  | REV<br><b>AA</b> |
| <small>PROPRIETARY &amp; CONFIDENTIAL<br/> THE INFORMATION CONTAINED IN THIS DRAWING IS THE SOLE PROPERTY OF DECTRON LLC. ANY REPRODUCTION IN PART OR AS A WHOLE WITHOUT THE WRITTEN PERMISSION OF DECTRON LLC IS PROHIBITED.</small> |                         | ANGULAR<br>±2°   | FINISH<br><b>BLACK OXIDE</b>   |                  |
| SIZE<br><b>A</b>  | DO NOT SCALE DRAWING    |  | MATERIAL<br><b>DECTRON MATL #3001-877, BAR, ROUND, .875in G&amp;P 1045</b> |                  |
| DRAWN<br><b>CHASE</b>   | DATE<br><b>11/14/14</b> |  |  |                  |