

NO	PART#	REV	NAME	QTY.	SHIP W/ KIT
1	016-008-00		OILITE PLUS BEARING, .875 ID x 1.0 OD x 1.25	1	
2	007-031-00		SET SCREW, 1/4-28 X 3/16, BLACK OXIDE	1	

REVISIONS			
REV.	DESCRIPTION	DATE	APPROVED
L	0.265/0.270 WAS 0.217/0.225	11.06.10	STRO
M	ADD WELD NOTES, MOVE 1/4-28 TO FRONT FROM SIDE	12.07.10	STRO
AA	REV CHANGE	11.14.25	DMS

- ASSEMBLY NOTES:
- INSERT SET SCREW (2) BUT DO NOT TIGHTEN AGAINST BEARING

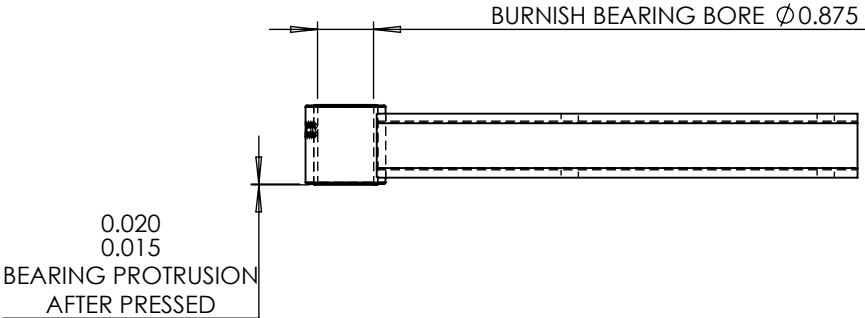
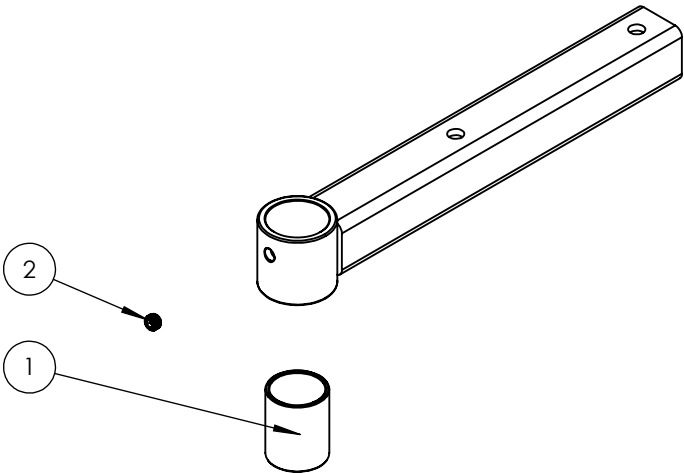

DECTRON LLC www.dectronusa.com		TOLERANCE STANDARDS	REV AA
<small>PROPRIETARY & CONFIDENTIAL THE INFORMATION CONTAINED IN THIS DRAWING IS THE SOLE PROPERTY OF DECTRON LLC. ANY REPRODUCTION IN PART OR AS A WHOLE WITHOUT THE WRITTEN PERMISSION OF DECTRON LLC IS PROHIBITED.</small>		.x ±.025 .xx ±.010 .xxx ±.005	70-0045-00 STRAIGHT BAR ARM END ATTACHMENT
SIZE A	DO NOT SCALE DRAWING	ANGULAR ±2°	STEEL
DRAWN CHASE	05.14.25		CARDINAL BLACK TEXTURE POWDER COAT T241-BK59